

GIS

Open House

Tuesday, June 24th, 2014 10:00 am - 2:00 pm

Sir Sandford Fleming College

School of Environmental and Natural Resource Sciences
Frost Campus, 200 Albert Street South, Box 8000
Lindsay, ON K9V 5E6

You are cordially invited to attend the Geographic Information Systems Open House at Sir Sandford Fleming College, Lindsay, Ontario. The graduates of the GIS-Application Specialist and GIS-Cartographic Specialist programs will be showcasing their collaborative projects, for you. The projects include:

- Mapping Invasive Species for Risk Management: Monitoring the Brown Spruce Longhorn Beetle in Canada for the Forest Health Unit of the OMNR
- Emily Landfill Mining Project –Design and Development of Final Grades for the CoKL
- Control Room Map Development for Entegrus Powerlines
- Early Archaeological Research GIS Proj. for Ministry of Tourism, Culture and Sport (OMTCS)
- Rover Trafficability on Mars for the University of Western Ontario
- Headwater Mapping for the Ontario Headwaters Institute
- Online Subdivision Application for the County of Frontenac
- Monitoring Boreal Forest Birds Using Roadside Surveys: investigating potential biases in disturbance rates and implications for survey design for Environment Canada
- Lindsay 360: Mapping the Local Agricultural and Rural Landscape for OMAFRA
- Advancing Habitat Connectivity In The Kawarthas for the Kawartha Land Trust
- Land Use Impacts on Great Lakes Water Quality & Algae for Ontario MOE
- Automating Municipal Zoning/permit Mail-out Address for City of Kawartha Lakes (COKL)
- Landscape Factors Influencing Bank Swallow Colony Distribution and Belted Kingfisher Nesting Locations Across Northern Ontario for the OMNR
- Interactive Map Development in Haliburton for Communities in Action Committee
- Spatial Distribution and Movement Patterns of Five-lined Skinks in the South Shield Region of Ontario for Prof. Josh Feltham at SSFC
- Greenway Interactive Map for Essex Region Conservation Authority
- Visual Representation of Cordon Count Data for Data Management Group at U. of T.
- Hazard Land Common Operating Picture for Central Lake Ontario Conservation Authority
- Tourism Story Maps for County of Brant
- Archaeological Report Spatial Query Database for OMTCS
- Mapping Post-Sochi Olympics 2014 for Radio Laurier

Please confirm your attendance and the number of guests by contacting the following individuals:

Samantha Rice or Hilary Barr (GIS – Application Specialist & Cartographic Specialist Candidates, respectively)
Samantha.rice@flemingcollege.ca OR Hilary.barr@flemingcollege.ca

Complimentary parking will be provided upon arrival.

For further information please call:
Stewart O'Brien (faculty, GIS-AS/GIS-CS Programs)
705-324-9144 ext. 3238

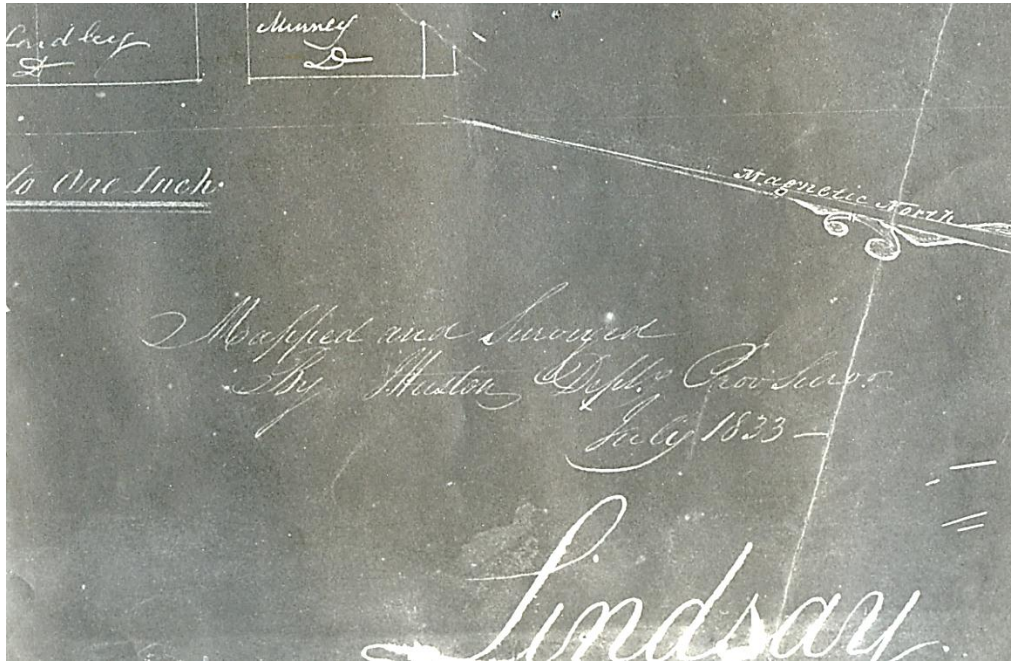

Detail of the 1833 map of downtown Lindsay, depicting Magnetic North, as it was then, and the name of the surveyor responsible, J. Huston. Lindsay is situated on the scenic Scugog River, approximately 43 kms. west of Peterborough, Ontario.

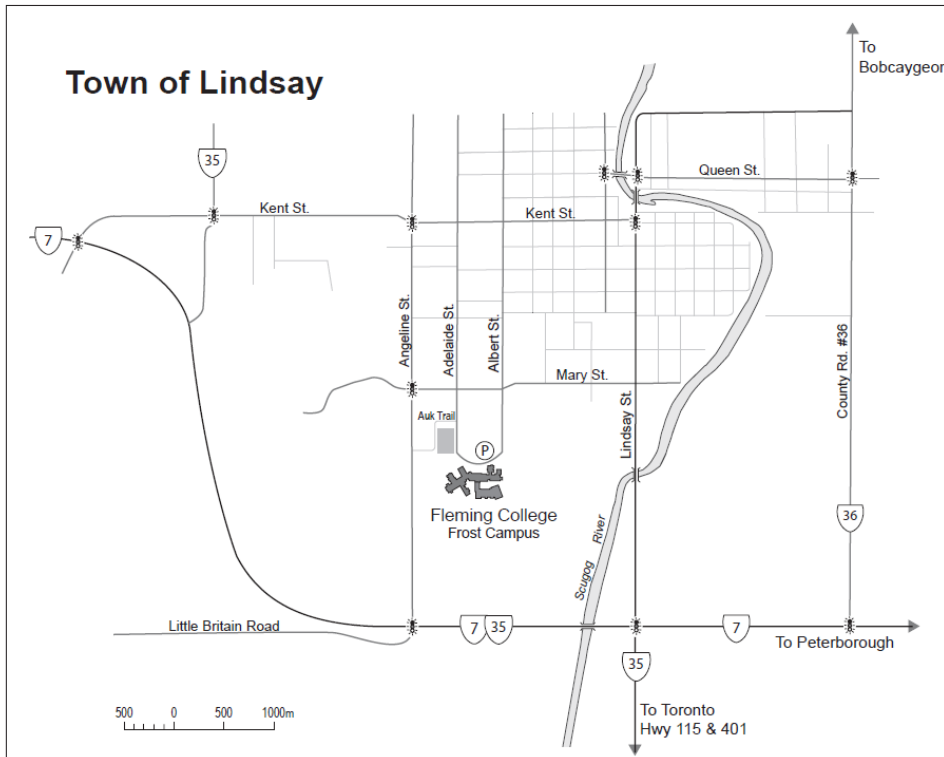

Open House Coordinates : Fleming College
 200 Albert Street South
 Lindsay, ON.
 K9V 5E6

UTM
 zone 17
 680172mE
 4912183mN